

APPLICATION:

PRODUCT NAME:

**SINGLE DECK 3/4" POT FILLER
WITH VACUUM BREAKER**

JOB NAME:

_____ SPECIAL CONFIGURATION
(CHECK BASE MODEL AND OPTIONS)

QUANTITY:

ITEM NO.:

MODEL:

5040

OPTIONS OR MODIFICATIONS:

- VANDAL RESISTANT KIT
- HANDLES (LEVER OR WRIST) CIRCLE STYLE
- OTHER _____

FEATURES:

CONTROL VALVE

- * SINGLE DECK MOUNT
- * STEM - LEFT HAND
- * HOT & COLD INDEX BUTTONS
- * SWIVELING SEAT DISKS
- * STAINLESS STEEL SEATS
- * STAINLESS STEEL SEAT SCREWS
- * STAINLESS STEEL HANDLE SCREWS

HOSE

- * 72" LG. HEAT MASTER FDA NITRILE/ARAMID
- * NSF-51 (100 PSI W.P. AT 300°F) CONSTANT
- * RENEWABLE END FITTINGS & BUMPER
- * INLET - 360° SWIVEL VACUUM BREAKER
- * OUTLET - 360° SWIVEL SPOUT WITH VINYL FINISH
- * 360° SWIVEL GOOSENECK
- * NON-MARRING GOOSENECK
- * 360° SWIVEL ATMOSPHERIC VACUUM BREAKER

SYSTEM LIMITS

- * TEMP: 40°F MIN. TO 140°F MAX.
- * PRESSURE: 200 PSI MAX. STATIC
- * 29 GPM AT 80 PSI

SHIPPING WEIGHT

- * 11.0 LBS

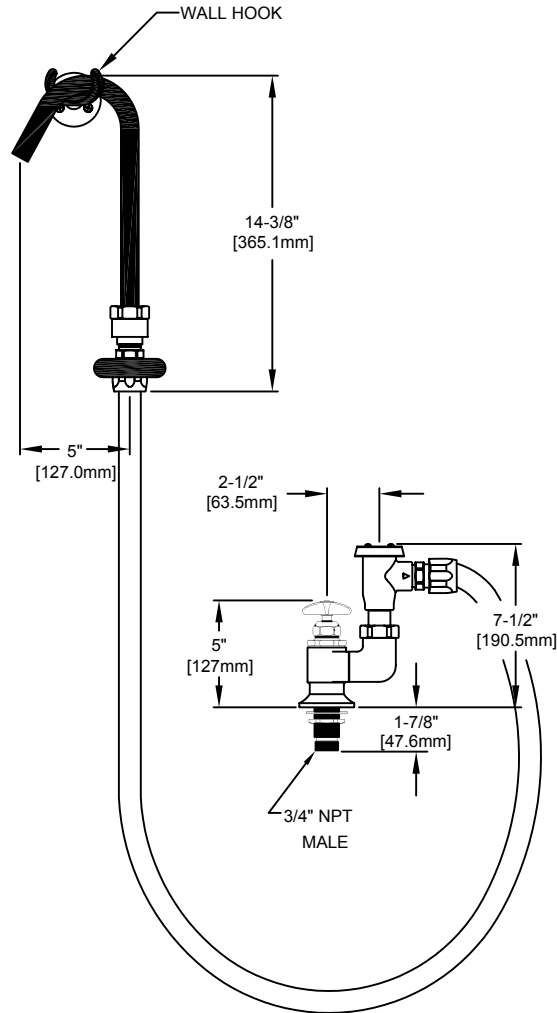

FOOTPRINT

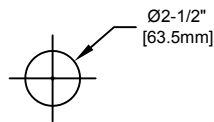

ROUGH-IN:

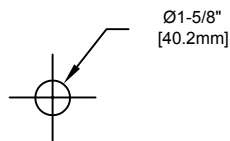

ANSI/A112.18.1M, ANSI/NSF 61.9

FISHER

FISHER MANUFACTURING COMPANY
TOLL FREE: 800-421-6162 - FAX: 800-832-8238
information@fisher-mfg.com - www.fisher-mfg.com